

BUCKET ELEVATORS

G50 SERIES

TWIN TRUNK CASING, CENTRIFUGAL DISCHARGE ELEVATORS

Model	G50-12	G50-14
Capacity - Free Flowing Material @ 110% Waterline Bucket Fill	4,134 BPH 5,145 ft ³ /hr 145.7 m ³ /hr	4,906 BPH 6,105 ft ³ /hr 172.9 m ³ /hr
Short TPH @ 15 lbs/Ft. ³	38.6	45.8
MTPH @ 15 lbs/Ft. ³	35	41.5
Short TPH @ 18 lbs/Ft. ³	46.3	54.9
MTPH @ 18 lbs/Ft. ³	42	49.8
Short TPH @ 22 lbs/Ft. ³	56.6	67.2
MTPH @ 22 lbs/Ft. ³	51.3	61
Belt Speed FPM	279 (1.42m/s)	
Head Shaft RPM	52	
Bucket Spacing	9" (228.6mm) Center to Center Spacing	
Head Casing	10 Ga. Sides, 7 Ga. Rim	
Head Shaft Bearings	Sealed Pillow Block Ball Bearing Optional Tapered Roller	
Head Pulley	20" (508mm) Dia. w/ Vulcanized Rubber Lagging	
Buckets	12" x 8" (305mm x 203mm) HDPE	14" x 8" (356mm x 203mm) HDPE
Belting	14" (356mm) UNI-PLY 250 PIW	15" (381mm) UNI-PLY 250 PIW
Legging	14 Ga. Twin Leg Seam Welded Columns	
Boot Casing	10 Ga.	
Boot Shaft Bearings	Sealed Two Bolt Flange Ball Bearing	
Boot Pulley	20" (508mm) Dia. Self-Cleaning Wing Pulley	
Construction	Powder Coated Carbon, Galvanized, or Stainless Steel	
Drive Package	Optional	
Motor	Optional	



The head contour, pulley diameter, bucket size, and belt speed have been carefully selected to maximize capacity and minimize product damage. This elevator follows the guidelines of the American Peanut Sheller's Association, Inc. and the U.S. Department of Agriculture.

Available in powder coated carbon, stainless, or galvanized steel.

WHAT THE INDUSTRY IS BUILT AROUND

800.553.4446 | WWW.UNIVERSALINDUSTRIES.COM

BUCKET ELEVATORS | G50 SERIES

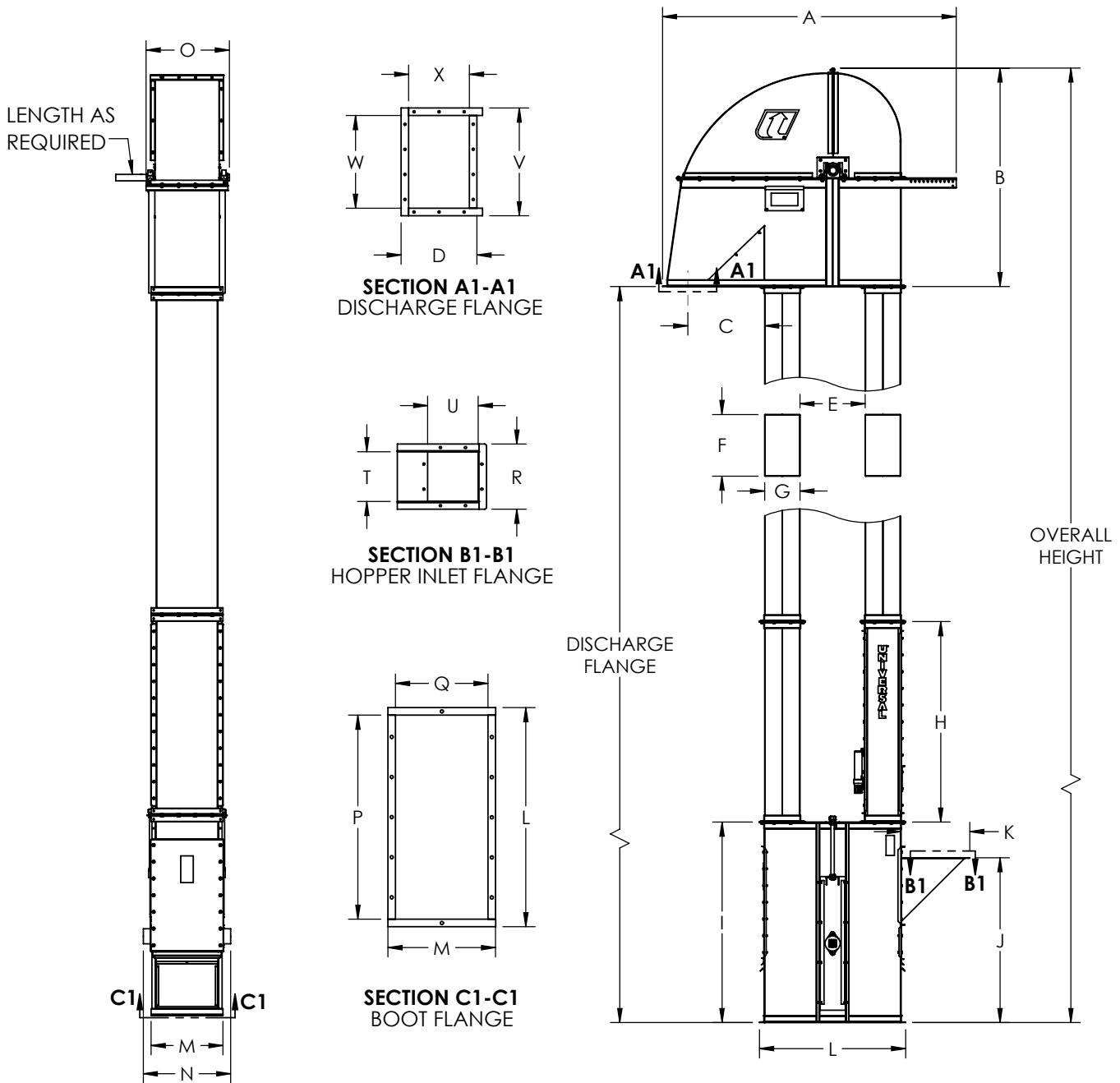

Unit	A	B	C	D	E	F	G	H	I	J	K	L	M	N	O	P	Q	R	T	U	V	W	X
in	87.9	65.4	23	15.1	19.8	18.4	10.6	60	60	49.4	20.5	43.7	21.5	26.1	24.9	40.7	18.5	13.0	9.9	10.1	21.5	18.5	12.1
mm	2232	1661	584	384	504	468	268	1524	1524	1254	521	1110	546	664	633	1034	469	330	252	256	546	470	308



NOTE: Unit application, location and specifications determine the type, quantity and/or placement of electrical, electrical safety or other safety controls required. Whether these controls are supplied by Universal Industries or another supplier, all OSHA safety and health standards, the National Electrical Code and local codes must be met and followed. Because we constantly strive to provide the finest material handling equipment, establishing industry standards, specifications must remain subject to change without notice.