

SLIDER BED BELT CONVEYORS



UNIVEY® MPC CONVEYOR

A COST EFFECTIVE, LOW CAPACITY CONVEYOR THAT IS IDEAL WHEN SPACE LIMITATIONS ARE A CONCERN.

Slider Bed Belt Conveyors are ideal for handling products that require gentle handling, such as seed or other bulk materials, food products, or chemicals/powders. Our wide variety of Slider Bed Conveyors reach a broad range of capacities and have various characteristics that make each conveyor's design uniquely perfect for handling specific bulk products.

Offered with industrial strength lining options that make them an ideal solution for shorter spans when space is a concern. The heavier construction and various options and accessories allow the Slider Bed Conveyors to handle harsher materials with ease.



Model	MPC 16	MPC 24
Capacity @ 200 FPM	2,000 ft ³ /h (56.63 m ³ /h)	3,750 ft ³ /h (106.19 m ³ /h)
Belt Width	16" (406.4mm)	24" (609.6mm)
Length (Minimum)	5' (1.5m) Center to Center	
Length (Maximum)	30' (9.1m) Center to Center	
Belt Speeds	25 - 200 FPM (0.13 - 1.02 m/s)	
Head Shaft Bearings	Sealed Two Bolt Flange Ball Bearing	
Head Pulley	4-1/2" (114.3mm) Dia. w/ Vulcanized Rubber Lagging	
Tail Shaft Bearings	Sealed Two Bolt Flange Ball Bearing	
Tail Pulley	4-1/4" (108mm) Dia. Self Cleaning Wing Pulley	
Belt Take-up	9-1/2" (241.3mm)	
Depth of Conveyor	4-1/2" (114.3mm)	
Depth of Trough	1-1/2" (38.1mm)	
Trough	16 Ga.	
Frame Construction	Powder Coated Carbon or Stainless Steel	
Drive (Optional)	Shaft Mounted Reducer	
Optional Accessories	Discharge Housing, Weather Covers, Inlet Hopper, and Skirted Sideboards	

WHAT THE INDUSTRY IS BUILT AROUND

800.553.4446 | WWW.UNIVERSALINDUSTRIES.COM

SLIDER BED BELT CONVEYORS | UNIVEY® MPC CONVEYOR

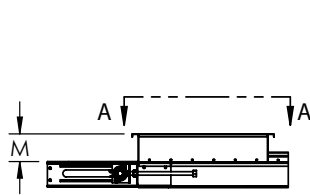
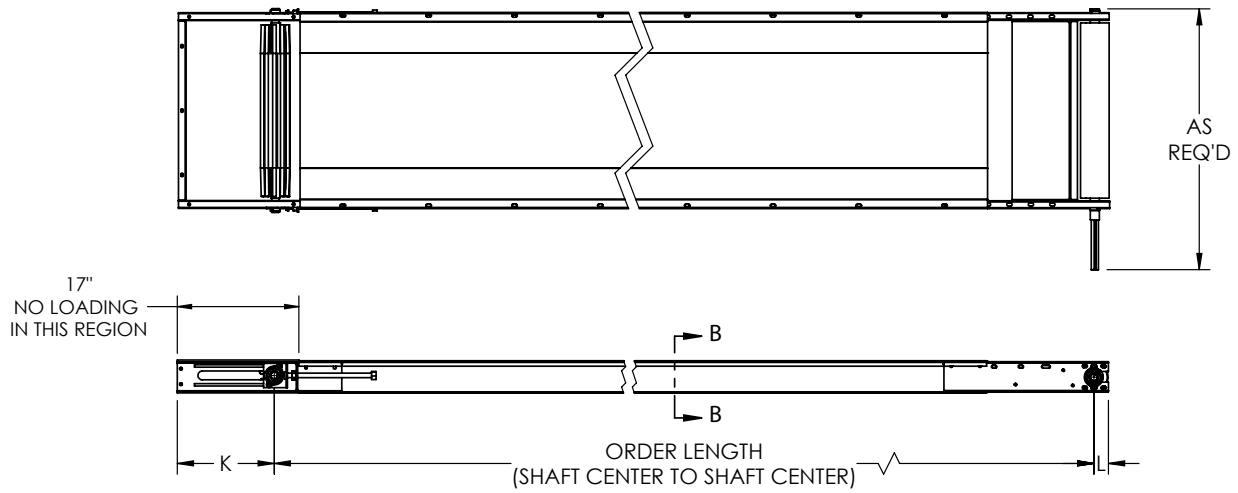

INLET HOPPER
(OPTIONAL)

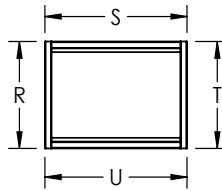

SECTION A-A
(INLET FLANGE)

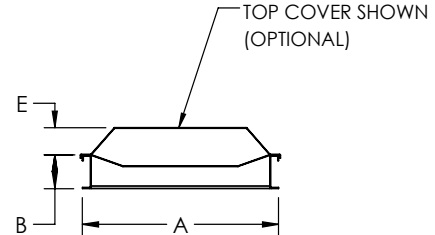

SECTION B-B
(TROUGH SECTION VIEW)

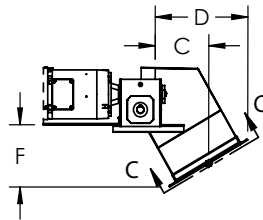

30° DISCHARGE HOUSING
(OPTIONAL)

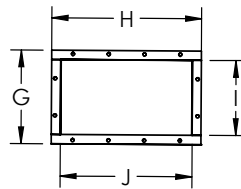

SECTION C-C
(DISCHARGE FLANGE)

MODEL	DIM	A	B	C	D	E	F	G	H	I	J	K	L	M	R	S	T	U
MPC 16	in	19.3	4.6	7.5	13	3.7	8.4	12.6	12.6	10.1	10.1	14	2	1.3	19.3	26.6	16.7	24
	mm	490	117	191	330	94	213	320	320	257	257	356	51	33	490	676	424	610
MPC 24	in	27.5	4.6	7.5	13	3.7	8.4	12.6	20.9	10.1	18.4	14	2	1.3	27.5	26.6	25	24
	mm	699	117	191	330	94	213	320	531	257	467	356	51	33	699	676	635	610



NOTE: Unit application, location and specifications determine the type, quantity and/or placement of electrical, electrical safety or other safety controls required. Whether these controls are supplied by Universal Industries or another supplier, all OSHA safety and health standards, the National Electrical Code and local codes must be met and followed. Because we constantly strive to provide the finest material handling equipment, establishing industry standards, specifications must remain subject to change without notice.