

# IDLER BED BELT CONVEYORS



## UNIVEY® TRI ROLL CONVEYOR

**HIGH CAPACITY WITH HIGHER RETENTION, WHILE STILL MAINTAINING A REDUCED FOOTPRINT.**

Idler Bed Belt Conveyors are perfect for handling bulk products across long distances and can handle a variety of products including aggregates, no matter if they require low belt speeds and gentle handling, or high belt speeds and increased capacities.

Idler Bed Belt Conveyors offer deep troughs and heavier construction that allow it to easily handle bulk and abrasive products at higher capacities, even in tight spaces. The industrial strength drives, as well as high quality options, such as stainless steel construction, allow these durable conveyors to achieve long run times and optimum performance.

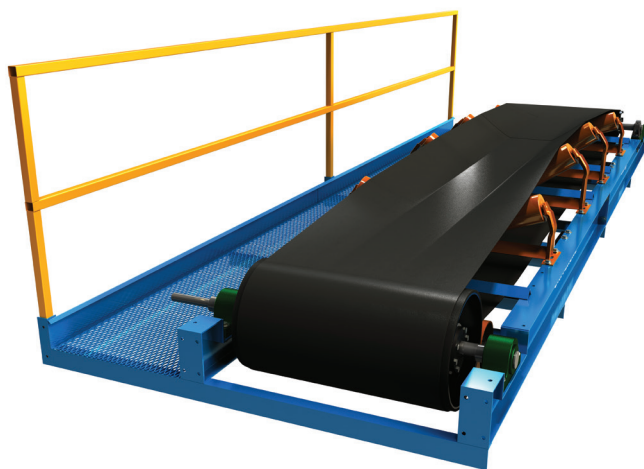

Model	TRC 18	TRC 24	TRC 30	TRC 36
Capacity @ 500 FPM	6,000 ft <sup>3</sup> /h (169.9 m <sup>3</sup> /h)	13,200 ft <sup>3</sup> /h (373.8 m <sup>3</sup> /h)	21,600 ft <sup>3</sup> /h (611.6 m <sup>3</sup> /h)	31,800 ft <sup>3</sup> /h (900.5 m <sup>3</sup> /h)
Belt Width	18" (457.2mm)	24" (609.6mm)	30" (762mm)	36" (914.4mm)
Unsupprted Length	20' (6.1m) Sections			
Length (Minimum)	37' (11.3m)			
Length (Maximum)	Consult Factory			
Belt Speeds	100 - 500 FPM (0.51 - 2.54 m/s)			
Head Shaft Bearings	Sealed Pillow Block Tapered Roller Bearing			
Head Pulley	16" (406.4mm) Dia. w/ 3/8" (9.5mm) Herringbone Lagging			
Idlers	4" or 5" (101.6 or 127mm) Dia. 35° CEMA-B			
Tail Shaft Bearings	Sealed Pillow Block Ball Bearing			
Tail Pulley	10" (254mm) Dia. Self Cleaning Wing Pulley			
Belt Take-up	18" (457.2mm)			
Frame	8" x 10" (203.2 x 254mm) Wide Flange Beam			
Construction	Powder Coated Carbon Steel			
Drive (Optional)	Shaft Mounted/V-Belt Reducer			
Optional Accessories	Disharge Housing, Top Weather Covers, Inlet Hopper, and Left and Right Catwalks			

WHAT THE INDUSTRY IS BUILT AROUND

800.553.4446 | WWW.UNIVERSALINDUSTRIES.COM

# IDLER BED BELT CONVEYORS | UNIVEY® TRI ROLL CONVEYOR

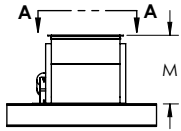
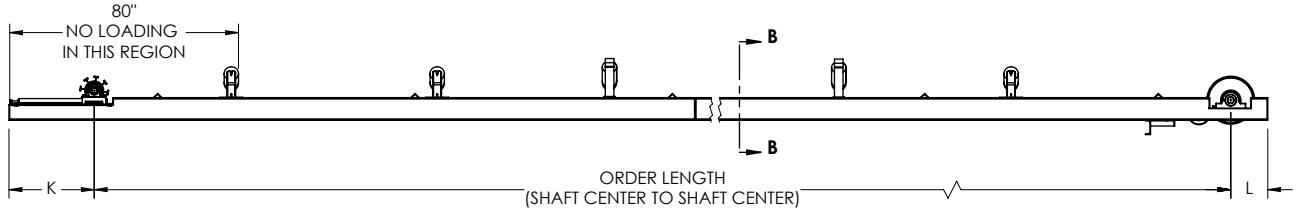
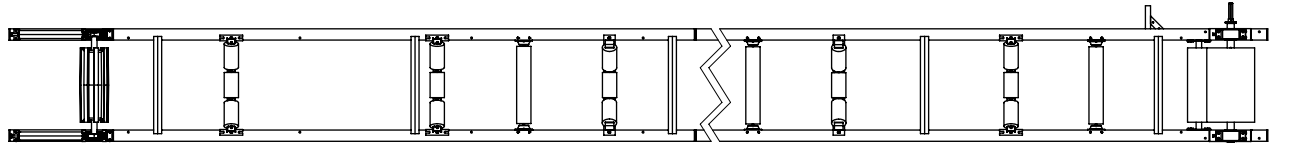

**INLET HOPPER**  
(OPTIONAL)

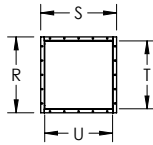

**SECTION A-A**  
(INLET FLANGE)

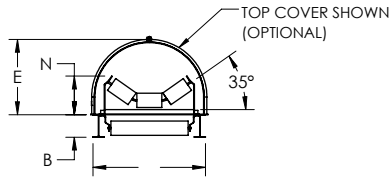

**SECTION B-B**  
(TROUGH SECTION VIEW)

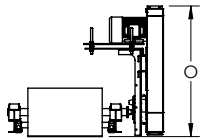

**SECTION D-D**  
(END VIEW)

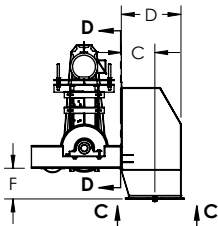

**90° DISCHARGE HOUSING**  
(OPTIONAL)

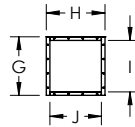

**SECTION C-C**  
(DISCHARGE FLANGE)

MODEL	DIM	A	B	C	D	E	F	G	H	I	J	K	L	M	N	O	R	S	T	U
TRC 18	in	33.4	7.9	11.7	20.9	22.3	10.7	20.5	20.5	18	18	30	12	24	11.1	46.1	20.5	20.5	18	18
	mm	848	201	297	531	565	272	521	521	457	457	762	305	610	282	1171	521	521	457	457
TRC 24	in	39.4	7.9	11.7	20.9	25.9	10.7	20.5	20.5	18	18	30	12	24	12.2	46.1	20.5	20.5	18	18
	mm	1001	201	297	531	657	272	521	521	457	457	762	305	610	310	1171	521	521	457	457
TRC 30	in	45.4	7.9	14.7	26.9	28.3	10.7	26.5	26.5	24	24	30	12	24	13.4	46.1	26.5	26.5	24	24
	mm	1153	201	373	683	718	272	673	673	610	610	762	305	610	340	1171	673	673	610	610
TRC 36	in	51.4	7.9	14.7	26.9	31.3	16.7	26.5	26.5	24	24	30	12	24	14.6	46.1	26.5	26.5	24	24
	mm	1306	201	373	683	794	424	673	673	610	610	762	305	610	371	1171	673	673	610	610



NOTE: Unit application, location and specifications determine the type, quantity and/or placement of electrical, electrical safety or other safety controls required. Whether these controls are supplied by Universal Industries or another supplier, all OSHA safety and health standards, the National Electrical Code and local codes must be met and followed. Because we constantly strive to provide the finest material handling equipment, establishing industry standards, specifications must remain subject to change without notice.