

DAKOSA CONVEYOR QUOTATION WORKSHEET:

DEALER NAME: _____
 STATE: _____
 CITY: _____

END-USER NAME: _____
 PHONE #: _____
 CONTACT: _____

UNIT SPECIFICATIONS (SELECT ONE):

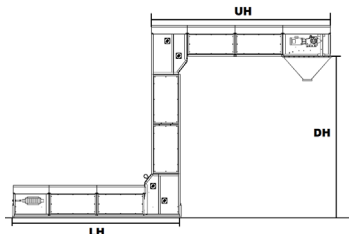

Z-SHAPE

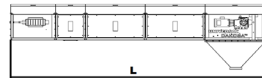

F-SHAPE

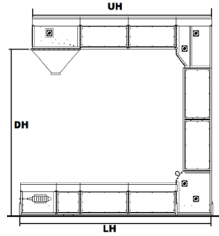

C-SHAPE

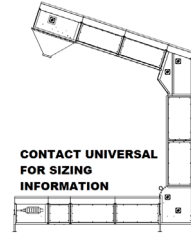

CONTACT UNIVERSAL
FOR SIZING
INFORMATION

OTHER

GENERAL INFORMATION:

NUMBER OF UNITS: _____ EA
 LOWER HORIZONTAL (LH,L): _____ FT
 DISCHARGE HEIGHT (DH): _____ FT
 UPPER HORIZONTAL (UH): _____ FT

MODEL SPECIFICATION (PICK ONE):

- 912 (615 ft³/h, 17.5 m³/h, 495 B/h)
- 918 (905 ft³/h, 25.5 m³/h, 730 B/h)
- 924 (1190 ft³/h, 33.5 m³/h, 960 B/h)
- 1212 (870 ft³/h, 24.6 m³/h, 700 B/h)
- 1218 (1300ft³/h, 36.8 m³/h, 1045 B/h)
- 1224 (1710 ft³/h, 48.4 m³/h, 1375 B/h)
- 1236 (2530 ft³/h, 71.6 m³/h, 2030 B/h)

STANDARD OPTIONS:

- DIVIDED APPLICATION
- INLET HOPPER (QTY: _____ EA)
- IM DISCHARGES (QTY: _____ EA)
- IM DISCHARGE HOPPER (QTY: ____ EA)
- AIR OPERATED (STANDARD)
- ELECTRONICALLY OPERATED
- DISCHARGE HOPPER

CONSTRUCTION MATERIAL (PICK ONE):

- CARBON STEEL (STANDARD)
- STAINLESS STEEL

COVER FITMENT:

- COVERS ON LOWER 8 FT (STANDARD)
- FULL COVERS
- NO COVERS

COVER CONSTRUCTION:

- SOLID COVERS
- VENTED COVERS

ADDITIONAL COVER OPTIONS:

- CLEAR SIDE COVERS (QTY: _____)
- CLEANOUT PANS

DRIVE OPTIONS:

- STANDARD MOUNT (RHS @ TAKE-UP)
- OPPOSITE MOUNT (LHS @ TAKE-UP)

DRIVE VOLTAGE: _____

OTHER REQUESTS/QUESTIONS:

PRODUCT SPECIFICATIONS:

PRODUCT: _____
 DENSITY: _____ LB/FT³
 DOES THE PRODUCT STICK TO PLASTIC?
 YES NO
 MOISTURE: _____ %
 IS PRODUCT FREE FLOWING?
 YES NO
 PRODUCT TEMPERATURE: _____ °F

LOCATION SPECIFICATIONS:

WILL UNIT BE INDOORS OR OUTDOORS?

EQUIPMENT USED TO FEED DAKOSA?

WILL THE DAKOSA BE STOPPED UNDER LOAD?
 *DAKOSA'S ARE NOT SOLD INTO APPLICATIONS
 WHERE THEY WILL BE STOPPED UNDER LOAD
 DURING NORMAL OPERATIONS
 YES NO